

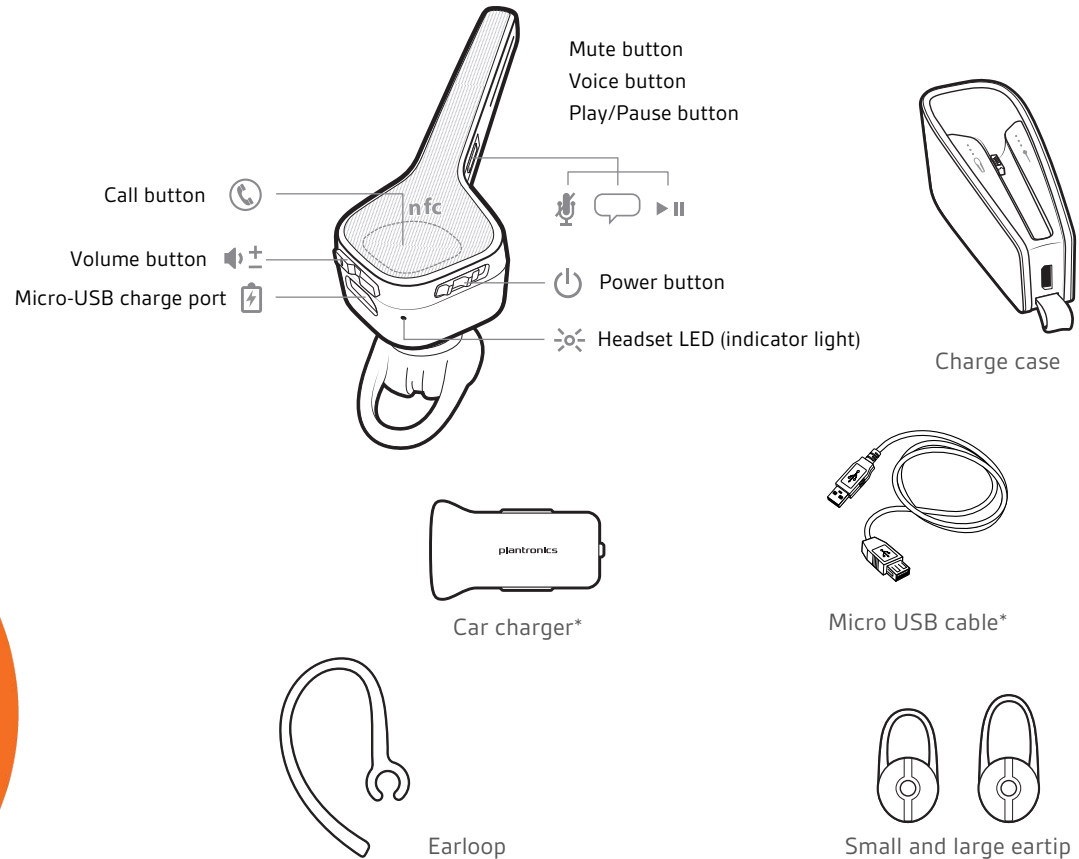

## Voyager Edge Series Quick Start Guide



For immediate  
technical or installation  
support, call us at

**800.641.6416**



**NOTE** \*Charger style may vary by product.

### Registering Your Product and Plantronics Software

Visit [plantronics.com/productregistration](http://plantronics.com/productregistration) to register your product online so we can provide you with the best service and technical support.

We also recommend that you install the Plantronics software located at [plantronics.com/software](http://plantronics.com/software). With it installed you can:

- Customize your headset and USB adapter settings to your personal preferences
- Automatically manage your PC multimedia so you never miss a call
- Quickly access links to product support and software/firmware upgrade information

# Charge case overview

**IMPORTANT** *The charge case is placed in deep sleep mode after manufacturing to save power and protect the battery. To wake-up the charge case, plug it into a power source for a minimum of 1 minute. The LED's flash when charging.*

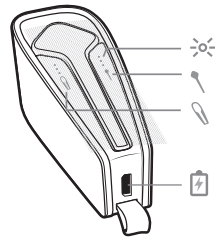

---

☀ Charge case LEDs; indicates case/headset battery status

---

🎧 Headset: Touch the icon to display the headset battery status

---

🔋 Charge case: Touch the icon to display the charge case battery status

---

🔌 Micro USB charge port

---

When fully charged, the charge case provides an extra 10 hours of battery life for the headset.

# Pair

**NOTE** If your phone supports Near Field Communication (NFC), go to **NFC pairing**.

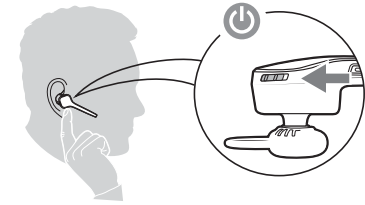

## Bluetooth pairing

- 1 Wearing your headset, power it on. You hear "welcome" in all the supported languages and then "pairing" in the default language. The headset LED flashes red and blue.
- 2 Activate Bluetooth® on your phone and set it to search for new devices.
  - **iPhone Settings > Bluetooth > On\***
  - **Android™ Settings > Bluetooth: On > Scan for devices\***

**NOTE** \*Menus may vary by device.

- 3 Select "**PLT\_Edge.**" If necessary, enter four zeros (0000) for the passcode or accept the connection. Once successfully paired, you hear "pairing successful."

## NFC pairing

- 1 Ensure NFC is on and your phone's display is unlocked.
- 2 Tap and hold the headset to the phone's NFC tag location until NFC pairing completes. If necessary, accept the connection.

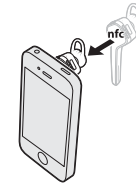

**TIP** Keep an eye on your Smartphone's screen for prompts to start and accept the pairing process.



**NOTE** The headset's NFC tag is located on the top of the headset. Phone NFC tag locations vary.

## Pair Another Phone

After pairing your headset to your phone, you may want to pair another phone.

- 1 Power on your headset.
- 2 Choose:
  - Tap the Voice button  and say "Pair mode"
  - Press and hold the Call button  until you hear "pairing"
- 3 Activate Bluetooth on your phone and set it to search for new devices.
- 4 Select "**PLT\_Edge.**"  
If necessary, enter four zeros (0000) for the passcode or accept the connection.

Once successfully paired, you hear "pairing successful" and the headset indicator lights stop flashing.

# Select language

Once your headset is paired and connected to your phone, you can change the headset language.

- 1 Wearing your headset, power it on.
- 2 Press and hold the Volume up + and down – buttons together until you hear “welcome.” The language selection directions repeat in every supported language.

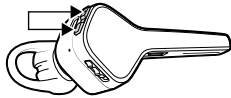

- 3 Follow the voice-guided prompts to select the headset language.

# Charge

It takes 90 minutes to fully charge the headset. The indicator light turns off once charging is complete.

**TIP** To reset the accuracy of the talk time prompt, deplete the headset battery then charge fully.

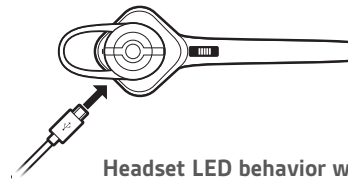

## Headset LED behavior while charging with micro USB cable

---

Off    Charging complete

---

● ● ●    Battery high

---

● ●    Battery medium

---

●    Battery low

---

● ● ●    Battery critical

---